

Parts Breakdown

Model MG-BR-0022 11067

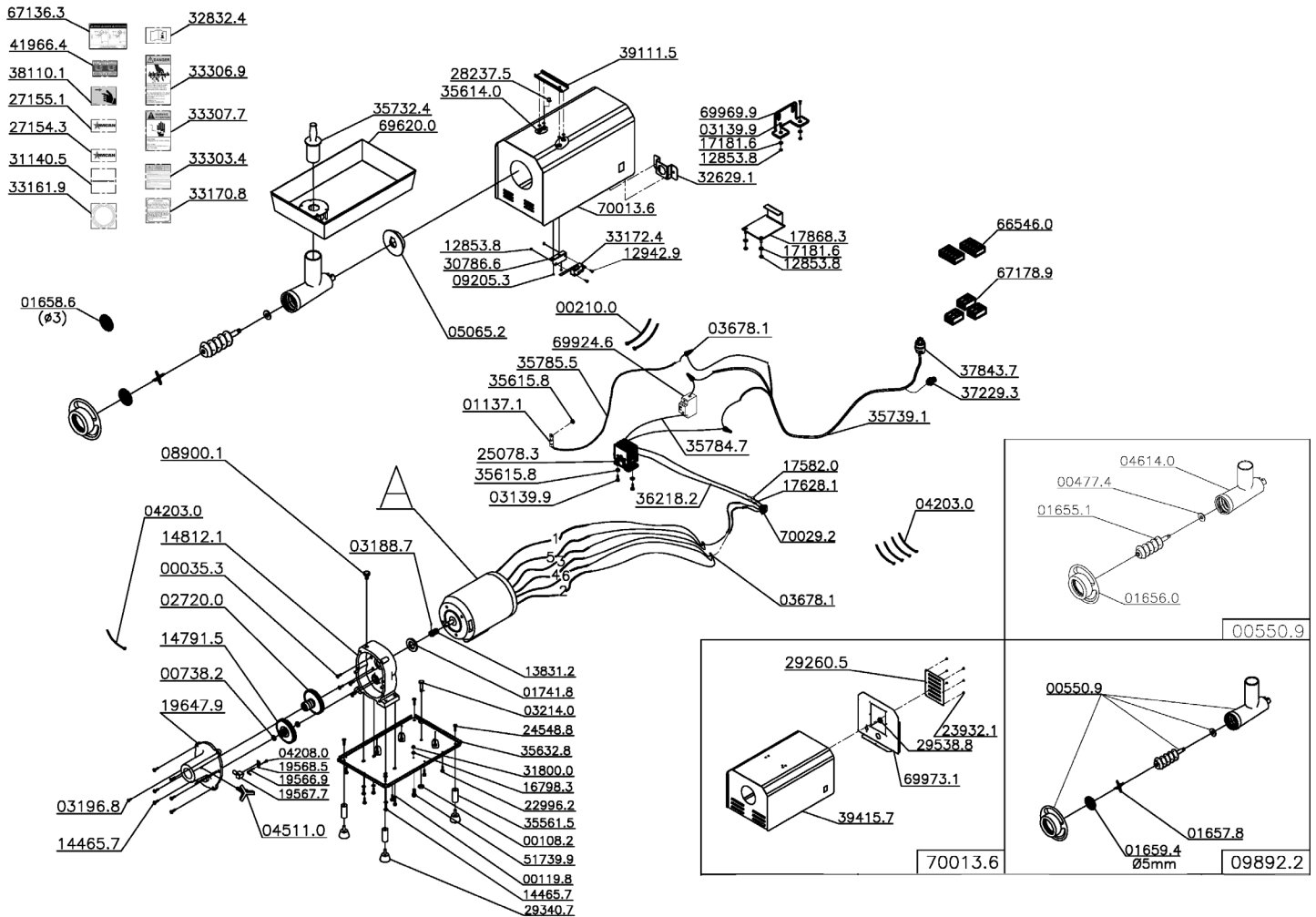

Parts Breakdown

Model MG-BR-0022 11067

Item No.	Description	Position	Item No.	Description	Position	Item No.	Description	Position
38388	PFS Sex UNC1/4x1 RTZB for 11067	00035.3	38581	Motor Gear for 11067	13831.2	67041	Key 40127 A2E3Q-NA KEMA for 11067	33172.4
38531	PCA Sex UNC 3/8 ZB for 11067	00108.2	65889	PFS M8x25 Din 933 Inox for 11067	14465.7	AF908	Attention Warning Label I/F for 11067	33303.4
30258	Washer L 5/16 ZB for 11067	00119.8	21842	Fiber Gear for 11067	14791.5	AH538	English/French Danger Label for 11067	33306.9
27688	Clamp K22 (T 50R) for 11067	00210.0	AH534	Eng. Box with Pin (Hammed C.) for 11067	14812.1	AF910	Warning Label Ingl./Franc. for 11067	33307.7
24022	Fiber Washer #22/98 for 11067	00477.4	30048	Cable 3x0.75mm for 11067	16798.3	AH539	PE Extensioner for 11067	35561.5
38548	Throat Set N°22 for 11067	00550.9	38045	Washer L.A3.2 Din 125 Stainless Steel for 11067	17181.6	AH540	PCA M6 Special ZB for 11067	35614.0
21843	Ball Bearing 6001 for 11067	00738.2	30050	Terminal Cover for 11067	17582.0	AH541	PCA M4 Special ZB for 11067	35615.8
AE670	Term. Eyelet for 11067	01137.1	38528	Term.Positiv Lock 2 A 4 for 11067	17628.1	AH542	Certified Base (Gray) for 11067	35632.8
38553	Worm No.22 for 11067	01655.1	78548	Strip for 11067	17868.3	AH544	Socket No.22 Certificate for 11067	35732.4
21581	Wheel for 11067	01656.0	38542	Copper Tube for 11067	19566.9	AH545	CB.3x5.3mm2 SJX2M Certif. for 11067	35739.1
38545	Blades for 11067	01657.8	38590	Lid Coupling Connection for 11067	19567.7	AH546	Wire El.Flex.5.3x300mm Cert. for 11067	35784.7
38518	Machine Plate 3" Dia for 11067	01658.6	38541	Meat Mincer Staple for 11067	19568.5	AH547	Wire El.Flex.5.3x670mm Cert. for 11067	35785.5
38546	Disc 5mm N°22 for 11067	01659.4	38539	Gear Box Lid (C.Martel.) for 11067	19647.9	AP014	El.Flex.5.3x650mm Cert. for 11067	36218.2
16401	Retainer Seal 00784BR1(F.0122) for 11067	01741.8	38593	Screw M5x6 Din 84 Stainless Steel for 11067	22996.2	AH548	Cable Press PG21 Black6PCA with Red.9A14 for 11067	37229.3
21844	Worm Gear for 11067	02720.0	38412	PFS M4x5 Din 7985 Inox for 11067	23932.1	AH549	American Plug Certif.30A 125V 4A262 for 11067	37843.7
AH532	PFS M4x16 Din 7985 ZB for 11067	03139.9	38177	PFS M10x12 Din 933 ZB for 11067	24548.8	AH550	Warning Label for 11067	38110.1
27695	Allen Screw M6x8 for 11067	03188.7	AH535	Cont.CWM32-00-30D13 110V 50/60Hz for 11067	25078.3	AH551	CS Tray Support for 11067	39111.5
38395	PFS M8x10 Din 933 ZB for 11067	03196.8	27720	Omcan Logo (Machine) for 11067	27154.3	AH552	CS Certified Cabinet for 11067	39415.7
38530	PFS Sex UNC3/8x2.3/4 RPZB for 11067	03214.0	30059	Omcan Packaging Logo for 11067	27155.1	AH555	Spanish/English Fragile Label for 11067	41966.4
27696	Nylon Cover CN 4478 for 11067	03678.1	AH536	Micro Drive Pin for 11067	28237.5	AF980	Screw M4x16 Din 933 Inox for 11067	51739.9
27699	Cramp T 18R Small for 11067	04203.0	AF901	Shutter 25x5x100 for 11067	29260.5	AM613	Wago Splicing Connector 5x0.25-4mm2 for 11067	66546.0
30038	Screw M3x6 Din 84 ZB for 11067	04208.0	67037	Foot Bor.Red.C/PFS M10x30 D.50x34x30 ALT for 11067	29340.7	AH556	Mouth Fixation Label for 11067	67136.3
21578	Knob with Bar M10x30mm for 11067	04511.0	78995	Rubber Buffer for 11067	29538.8	AM614	Wago Splicing Connector 2x0.25-4mm2 for 11067	67178.9
38564	Head N°22 for 11067	04614.0	AH537	Micro Support for 11067	30786.6	AH557	CS Tray No.22 Cert. for 11067	69620.0
38523	Rubber Cover for 11067	05065.2	67038	Grounded Wire Label for 11067	31140.5	AP015	Mini Monopolar Circuit Breaker 32A C Curve for 11067	69924.6
21577	Oil Cap for 11067	08900.1	67039	Nut M4 Din 985 Stainless Steel for 11067	31800.0	AP016	Circuit Breaker Support for 11067	69969.9
38404	Nut M4 Din 934 for 11067	09205.3	AF905	Thermal Protector Protection for 11067	32629.1	AP017	Back Cover for 11067	69973.1
38572	Complete #22 Meat Grinding Head for 11067	09892.2	67040	Instruction Manual Label for 11067	32832.4	AP018	Complete Cabinet for 11067	70013.6
38044	Nut M3 Din 934 Stainless Steel for 11067	12853.8	AF906	Thermal Protector Label Ingles for 11067	33161.9	AP019	Switch 10A 240V (Cod.Grainger 24A290) for 11067	70029.2
AP013	PFS M3x16 Din 7985 Inox for 11067	12942.9	AF907	Attention Ear Wire Label Ingles/Frances for 11067	33170.8			